



# Kerry Warehouse (Kwai Chung) 嘉里貨倉 (葵涌)

4-6 Kwai Tai Road, Kwai Chung, Hong Kong  
香港葵涌葵泰路 4-6 號

With a total gross area of approx 290,000 sq.ft, we provide professional warehousing services based on maximum efficiency, security and reliability for general cargoes and bonded goods.

總面積約 290,000 平方呎，儲存各類普通貨品及保稅貨品，以快捷的辦事效率，高質素的服務水平及嚴密的保安全管理，為客戶提供專業倉儲服務。



- Storage of general cargoes and bonded goods
- 16 storeys available from approximately 19,480 - 27,686 sq.ft
- Ceiling height approximately 13'11" - 19'6"
- Floor loading capacity approximately 250 - 300 lbs / sf
- 25 loading / unloading platforms plus access to 2 container platforms on each floor
- 1 high-speed passenger lift serving all floors
- 5 high-speed cargo lifts with 3,000 kg loading capacity each serving all floors
- 1 container hoist with lifting capacity of 35,000 kg to facilitate handling of 20' and 40' containers
- Automatic sprinkler system and fire-proof shutters on all floors
- 24-hour guard patrol
- Security alarm system linked to security control centre / police station
- Grade 1, rated by Fire Insurance Association
- 10 minutes to Kwai Chung container port
- 35 minutes to Hong Kong International Airport

- 儲存各類普通貨品及保稅貨品
- 樓高 16 層，每層面積約 19,480 - 27,686 平方呎
- 樓底高度約 13'11" - 19'6"
- 樓面負重約每平方呎 250 - 300 磅
- 共有 25 個貨物起卸台，另每層設有 2 個獨立貨櫃裝卸台
- 1 部高速客運電梯直達各層
- 5 部 3 噸高速載貨電梯直達各層
- 1 部 35 噸負重之貨櫃吊機，用於起卸 20 呎及 40 呎貨櫃，可將貨櫃直接運至各層
- 各層均設置自動消防花灑系統及防火閘門
- 24 小時守衛巡邏
- 保安警報系統連接保安中心 / 警局
- 為火險公會認可之 1 級貨倉
- 10 分鐘到達葵涌貨櫃碼頭
- 35 分鐘往香港國際機場

## Typical Floor Plan 平面圖

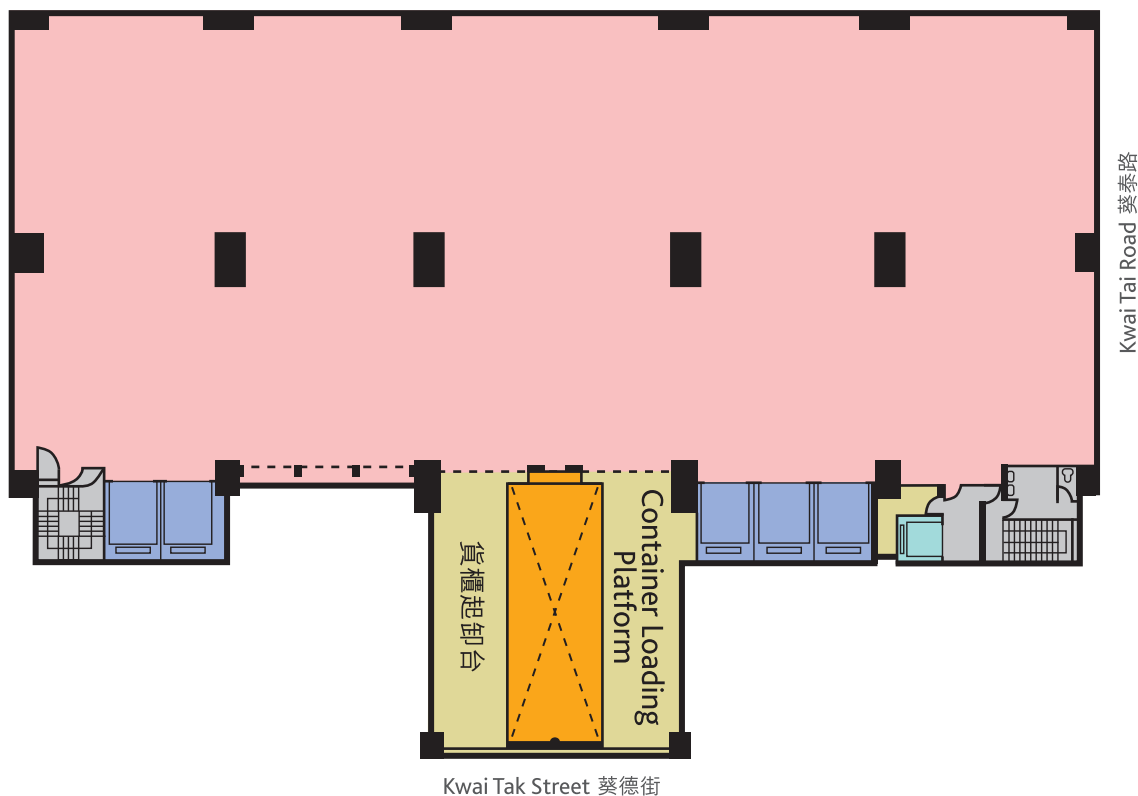

\* Not to scale. For identification purpose only.  
以上資料只供參考用。

While every care has been taken in preparing this brochure, all statements contained in the brochure are made without responsibility and no warranty whatever is given in respect of the correctness of the information contained in this brochure. None of the statements contained in this brochure is to be relied upon as a statement or representation of fact. Any interested parties shall satisfy themselves by inspection or otherwise as to the correctness of each of the statements contained in this brochure. 本書資料只供參考用。編訂過程已盡量嚴謹，然而對上述內容之全部或部份準確性，業主不作出任何保證，並不負上任何法律責任。有興趣人士如有任何疑問，應作全面了解及深入查詢。